



TARGE GUILLEMOT

Damen RSD 2513 Reversed Stern Drive Tug

GENERAL

Classification	Bureau Veritas UK MCA Workboat 2 - TUG + UMS + FIFI 1 + Water Spraying
Flag	British
Owner	Targe Towing Limited
Built	2021
Fire-Fighting	Full FiFi 1 (2800 m3/hr)

DIMENSIONS

Length overall	24.73m
Beam overall	13.13m
Max Draught	5.9m
Gross tonnage	244t

PERFORMANCE

Bollard pull	73.57t
Max Speed	12.9kn
Emissions standard	Tier III

PROPULSION SYSTEM

Main engines	MTU Type 16v 4000 M63L-1A - Tier III
Total power	4480 kw (6008bhp) at 1800rpm
Azimuth thrusters	Kongsberg US255 FP ASD
Propeller diameter	2500mm

TANK CAPACITIES

Fuel Oil	82.4 m3
Fresh Water	10.4 m3
Ad-Blue (Urea)	3.0 m3

AUXILIARY EQUIPMENT

Generator sets	2 x Caterpillar C4.4 TA, 81kVA, 400 V, 50 Hz
----------------	--

DECK EQUIPMENT

Main Towing Winch	Damen - TW - H - 30 - 175 SD Towing Winch equipped with 200m 56mm Lankhorst Lankoforce 12 strand towline with HMPE jacket MBL 228 tonnes with 2 x Lankhorst Lankoforce 25m Bridal Legs MBL 216 tonnes.
Tow Hook	Mampaey SWL 750kn 75t
Capstan	Electrically driven 5t at 15m/min

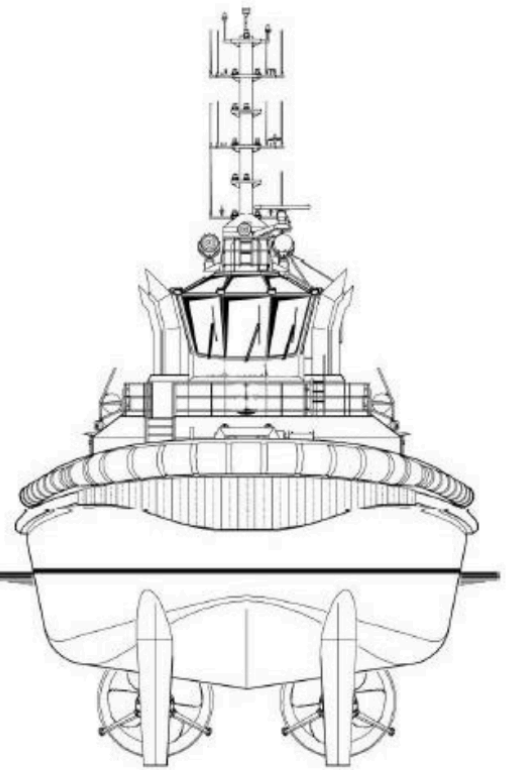
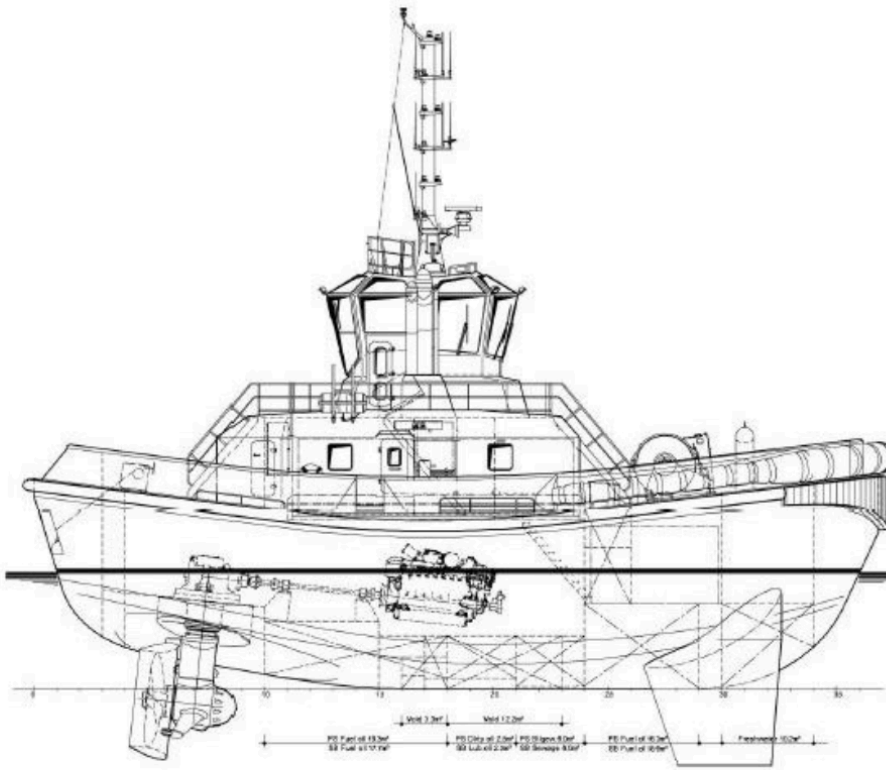

Main deck

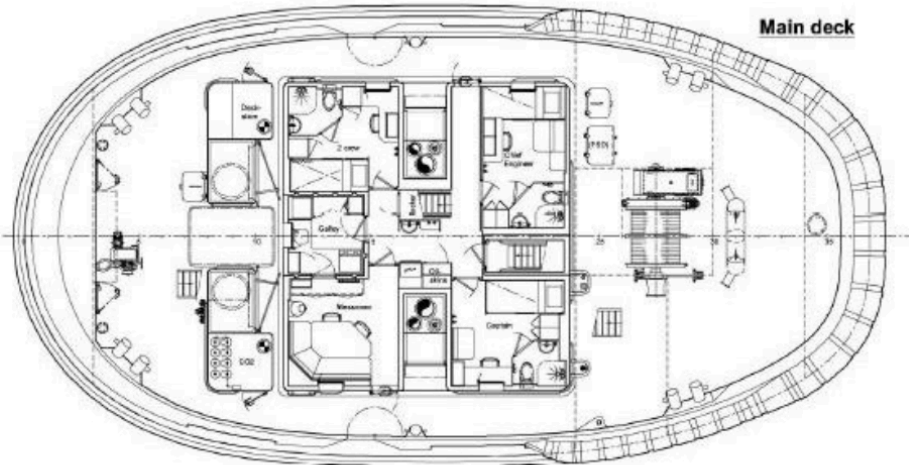

Bridge deck

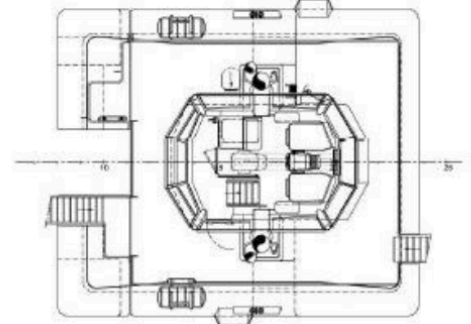

Below Main deck

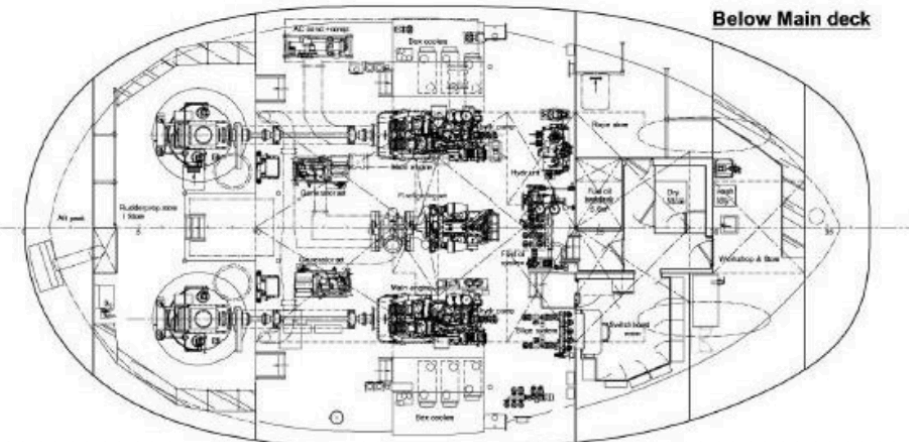

Top deck

